

Assembly Instructions

Q40 - NC

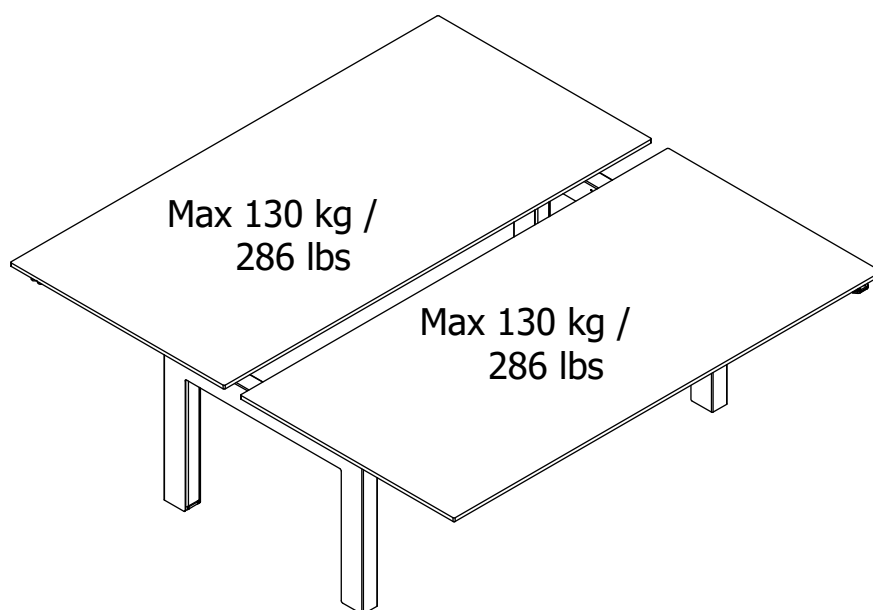

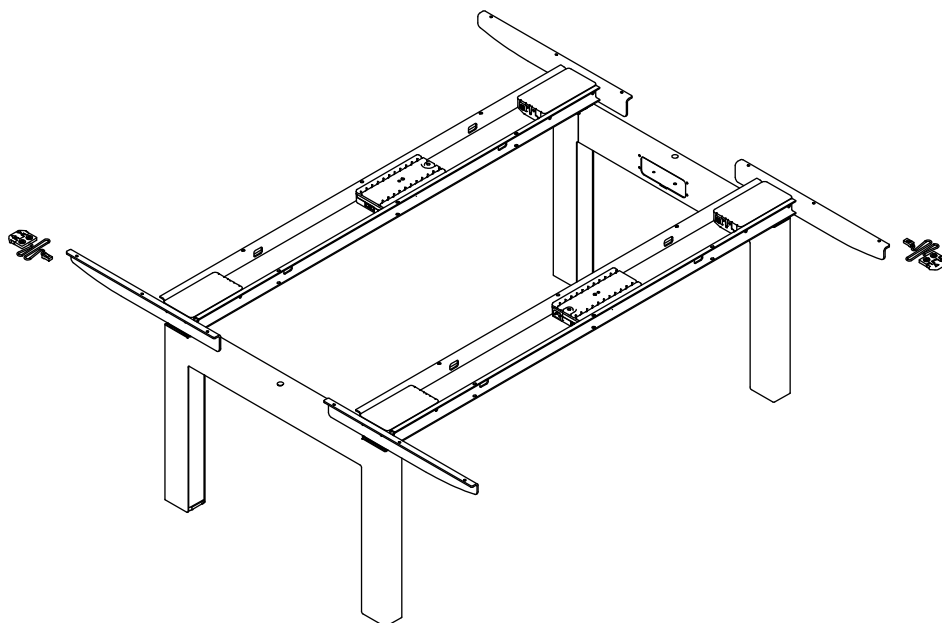
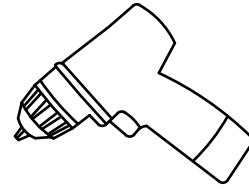
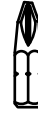
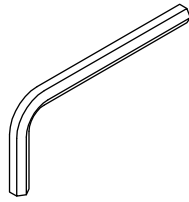
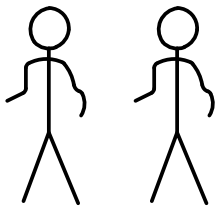

16 xA

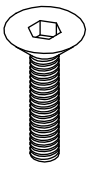

M6 x 25 mm
M 0.24" x 0.98"

24 xB

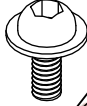

8 xB

M6 x 12 mm
M 0.24" x 0.47"

28 xC



ø4,5 x 16 mm
ø 0.18" x 0.63"

4 xD



ø4,5 x 45 mm
ø 0.18" x 1.77"

2 xE



ø16/ø12 mm
ø 0.63" x 0.47"

4 xF

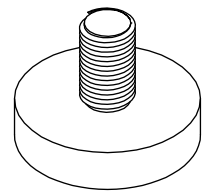

M8 x 14 mm
M 0.31" x 0.55"

2 xG

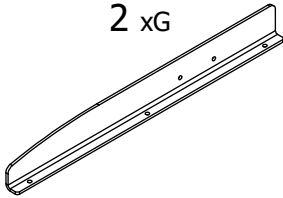

2 xH

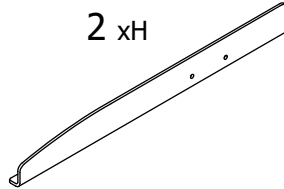

4 xJ

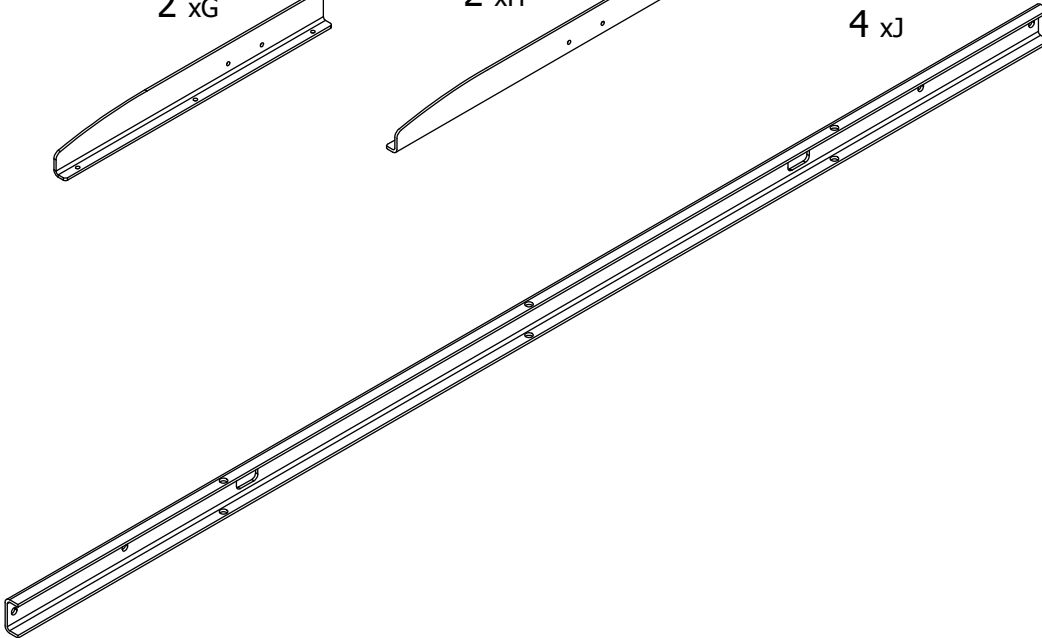

4 xK

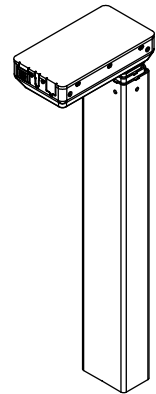

2 xL

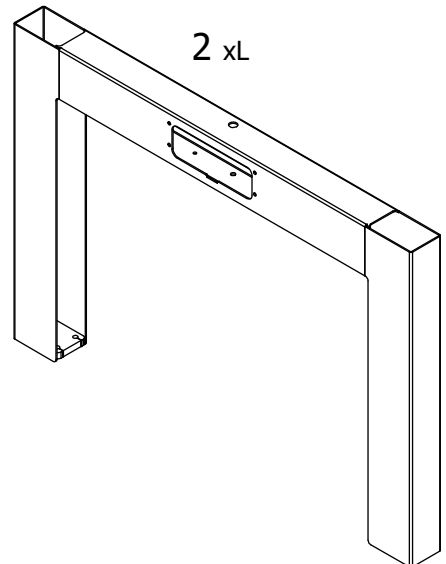

2 xM

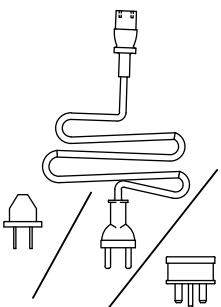

4 xN

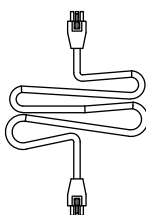

2 xO

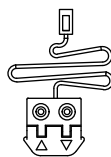

2 xP

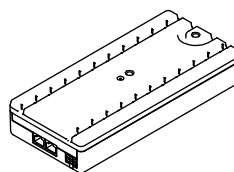

1 2 xE

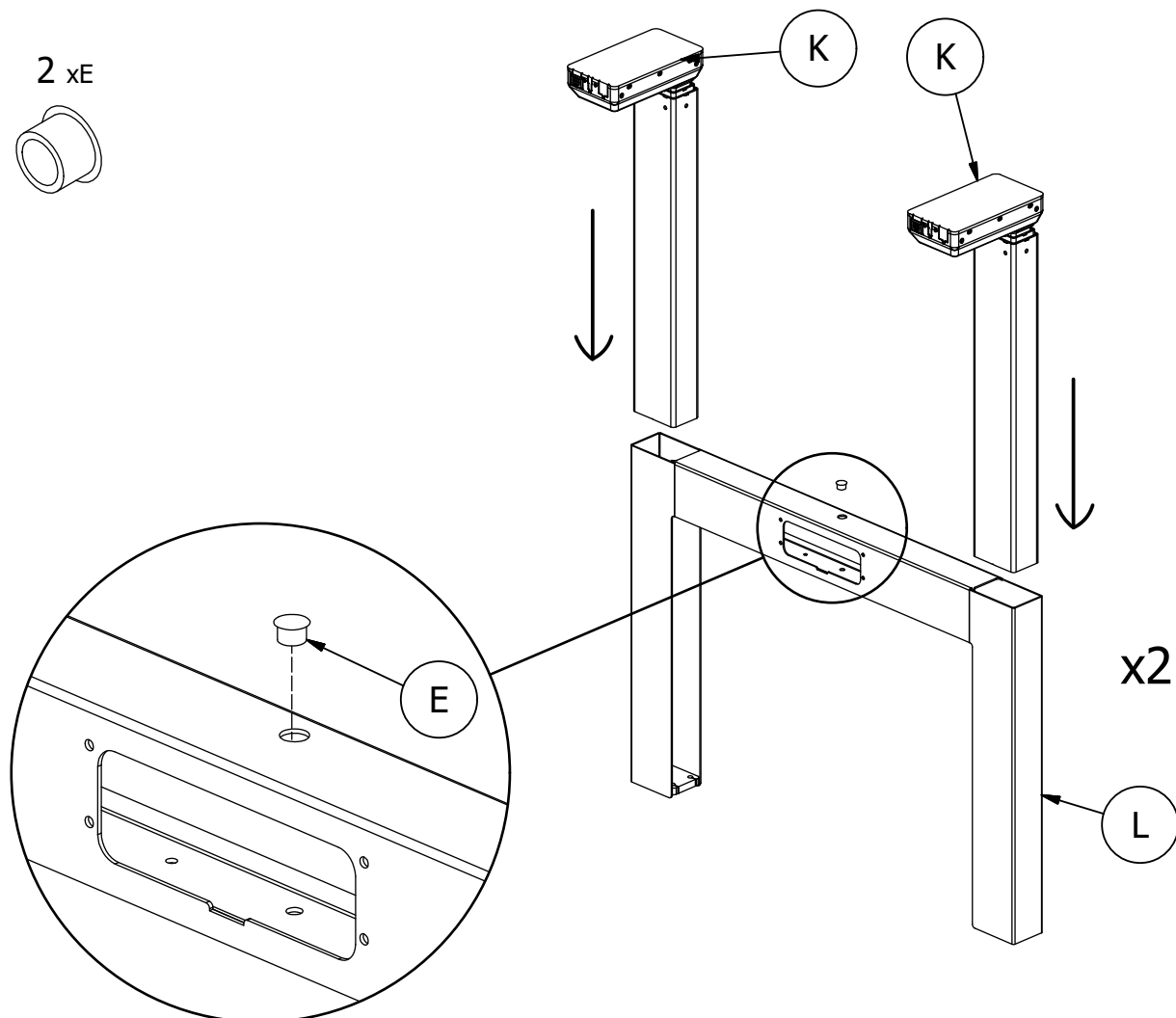

2 16 xA

4 xF

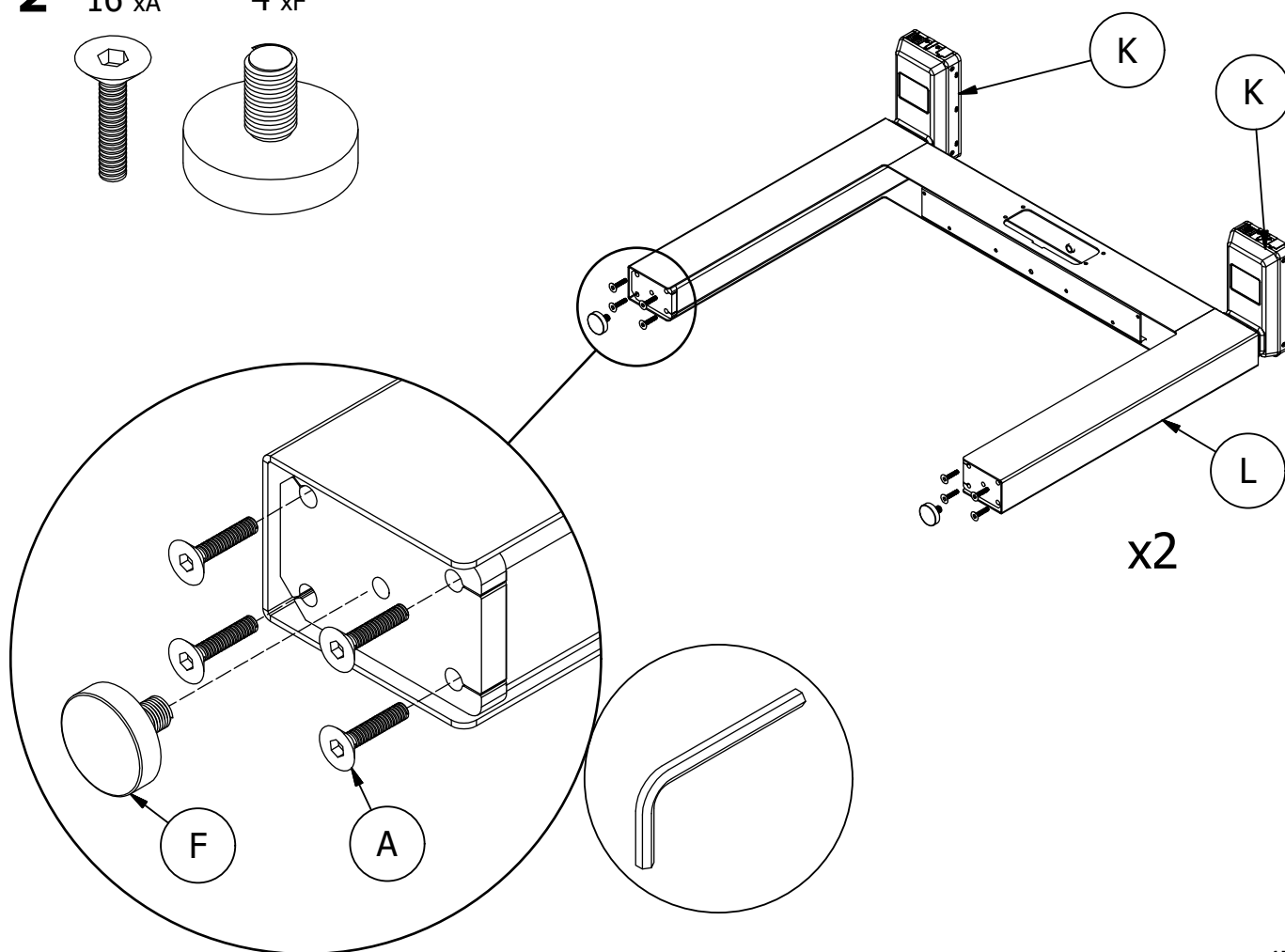
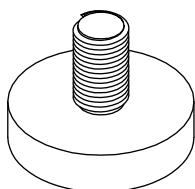
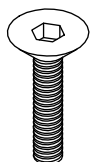

3 16 xB

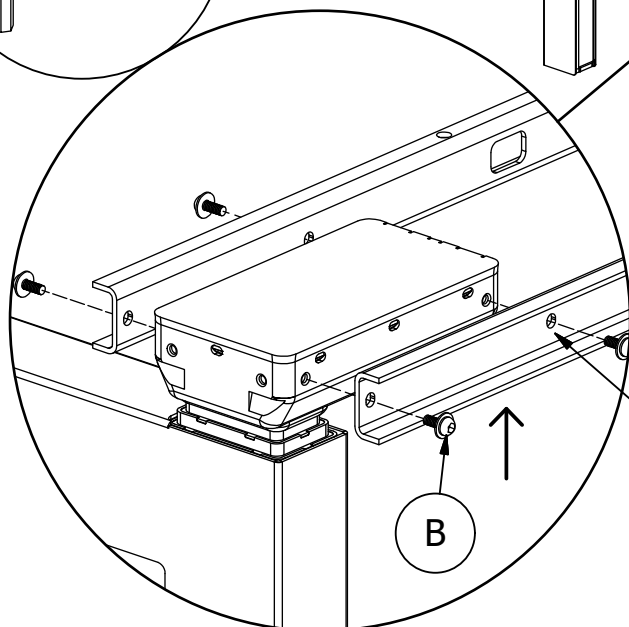
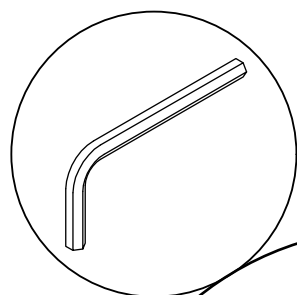
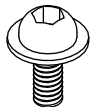

4 8 xB

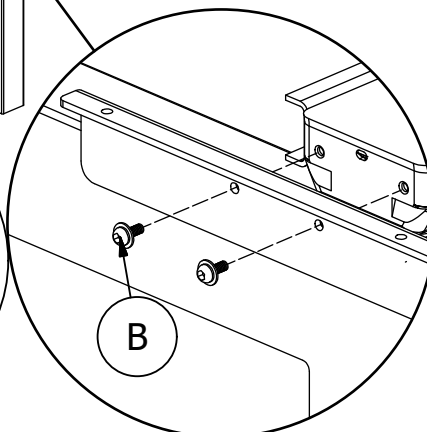
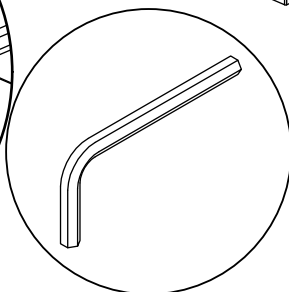
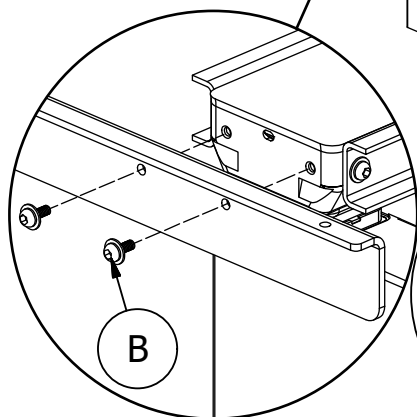
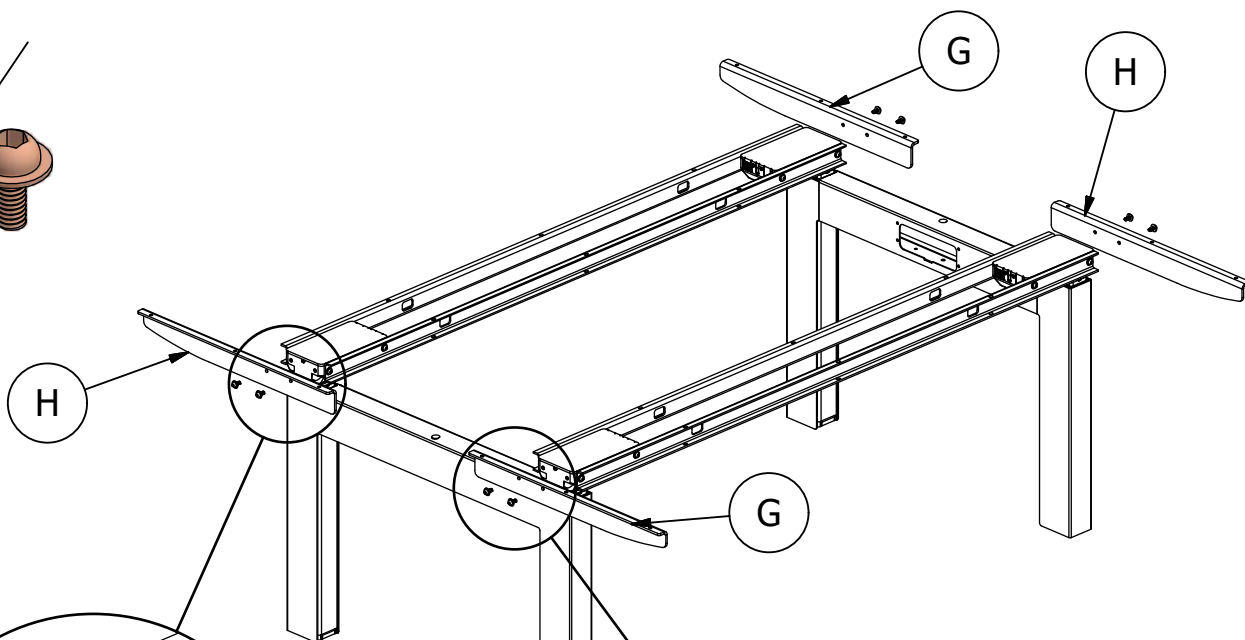
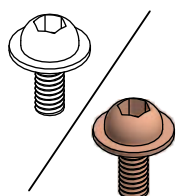

5

2 xM

4 xN

2 xO

2 xP

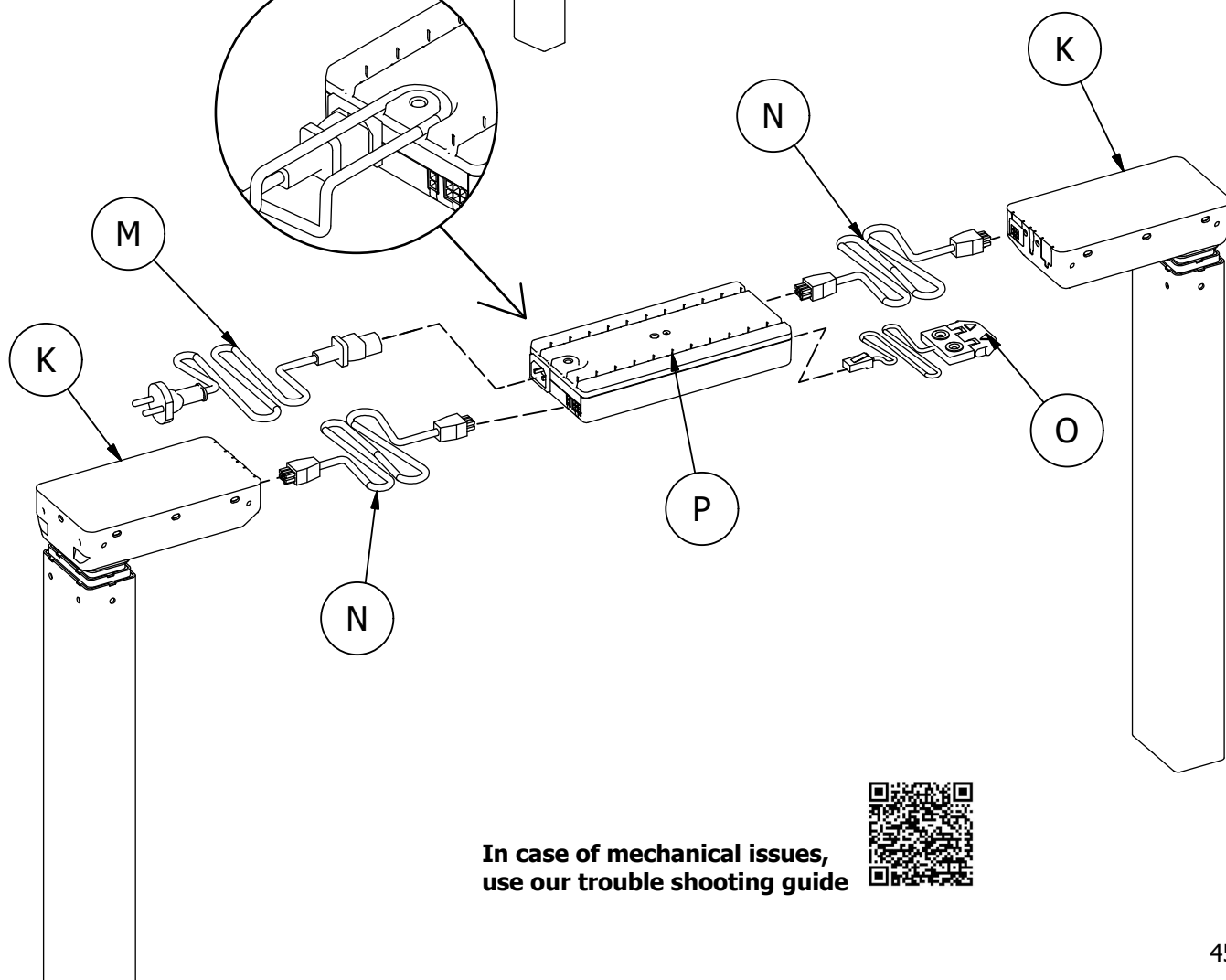
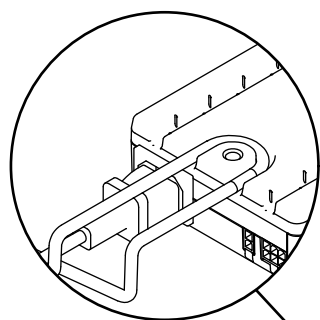
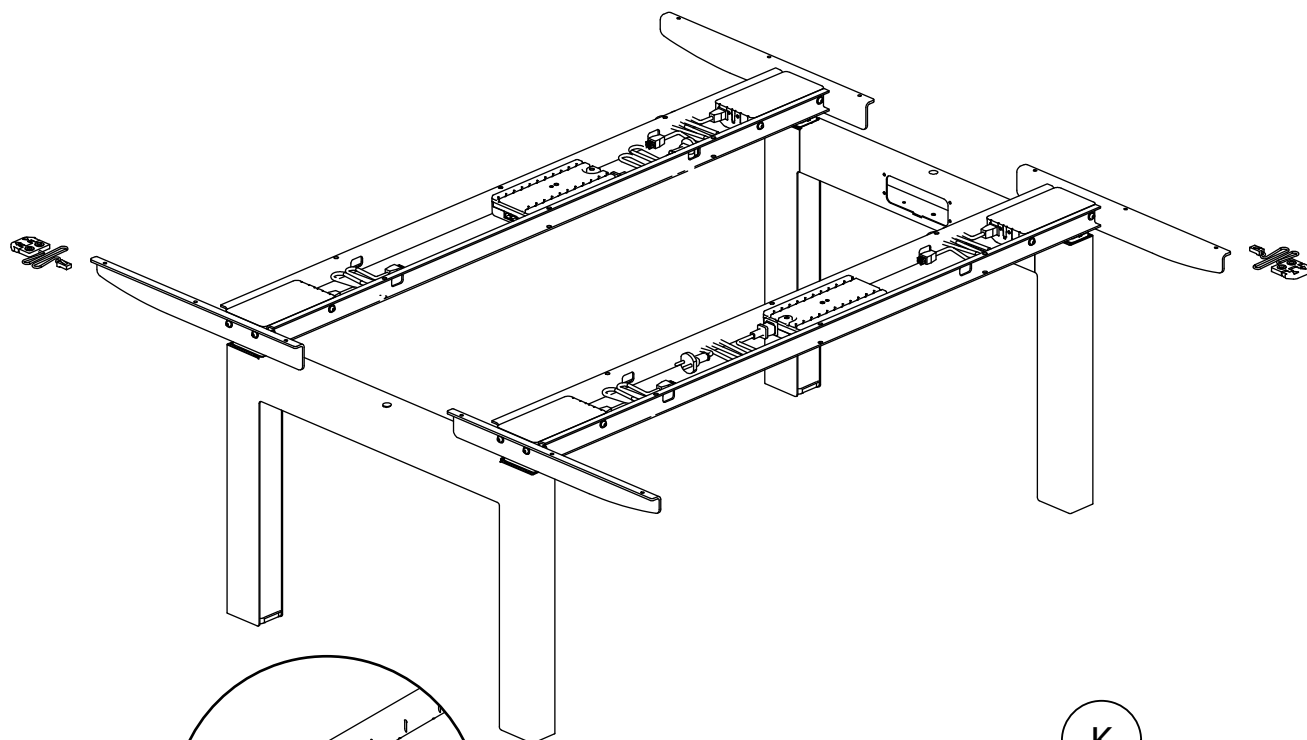
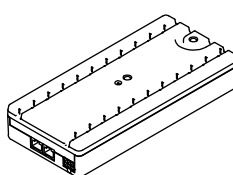
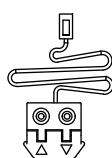
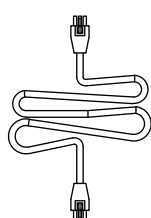
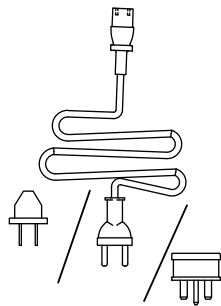

In case of mechanical issues,
use our trouble shooting guide



6 28 xC 4 xD

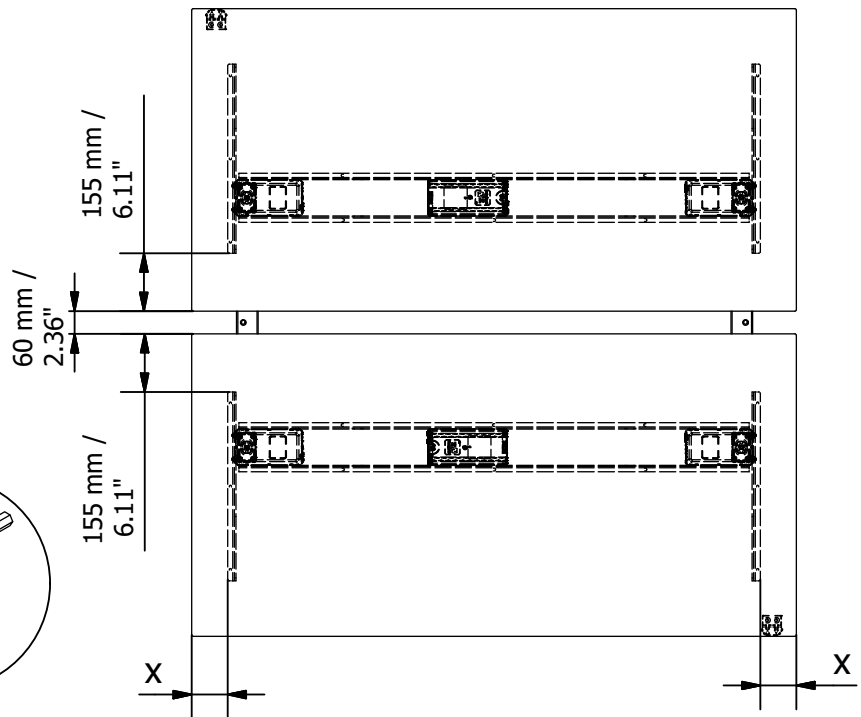
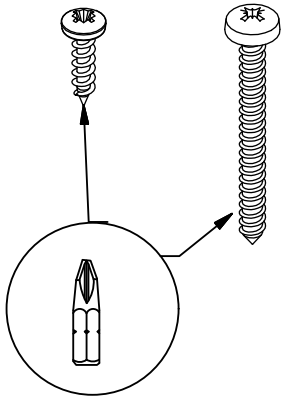

x16

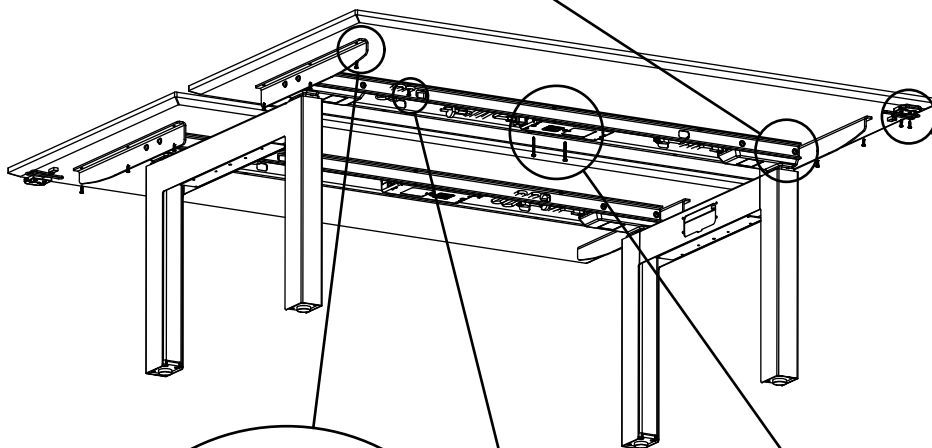

1.

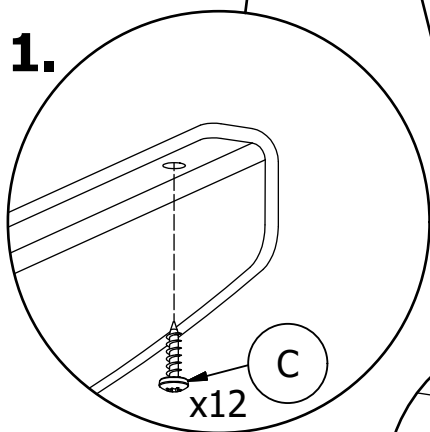

2.

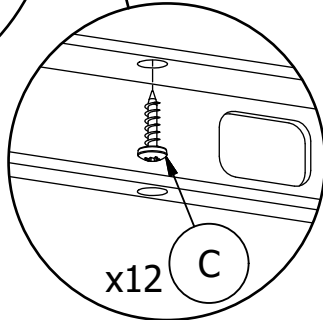

3.

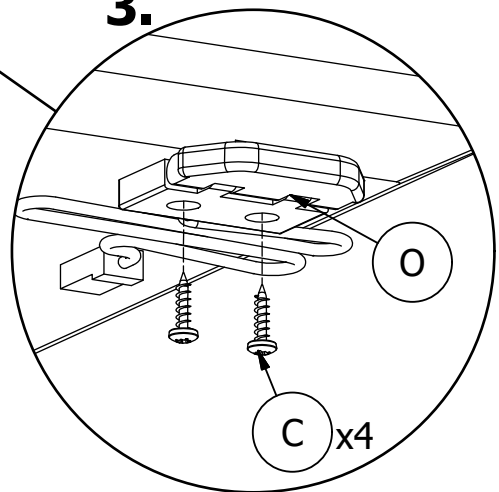

4.

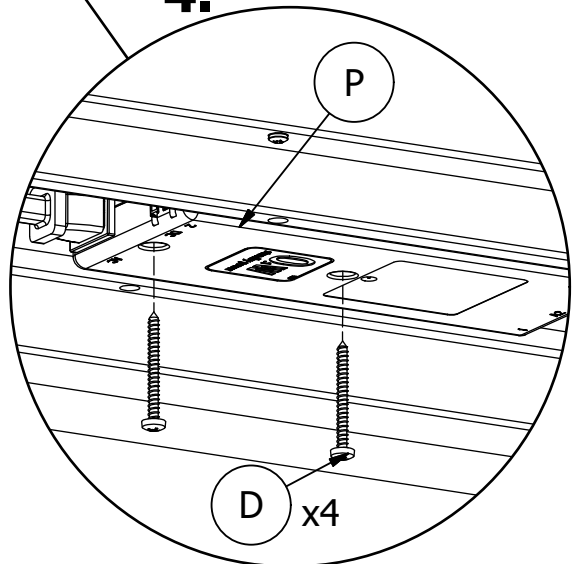



Furniture Care Instructions

Veneer Product:

The furniture is lacquered and do not require specific care.

Daily cleaning should be done using a soft dry cloth. Once in a while clean with a cloth rinsed with warm water and wrung out tightly.

Linoleum:

Daily cleaning of linoleum should be done using a mild cleaning solution. We recommend using cleaning product with a PH value between 5 and 9 in diluted form. We also recommend using a linoleum care product twice a year.

If very soiled use mild cleaning product to recommended dilution. Follow with clean water and linoleum specific care product.

Laminate:

No specific care required.

Laminate is a plastic product and can be cleaned using most non-abrasive cleaning products.

General:

Never place your furniture in a wet room, or other places with large changes in temperature and moisture. This will compromise the look and life span of the furniture.