



D'ANGLETERRE

COPENHAGEN

EST. 1755



## CONTENTS

## PAGE

HOTEL	6
ROOMS AND SUITES	11
RESTAURANT MARCHAL	15
BALTHAZAR CHAMPAGNE BAR	18
KRUG AFTERNOON TEA	21
CREATIONS STUDIO	23
MAISON	24
WEDDINGS	26
EVENTS	28
MEETINGS	30
AMAZING SPACE SPA AND POOL	32
LOCATION	34









## THE HOTEL

The d'Angleterre is the result of a love affair between two young people. In the middle of the 1700's, Jean Marchal, a French servant, and Maria Coppy, daughter of the royal family's chef, fell in love. The pair complimented each other perfectly – she was a genius in the kitchen and he knew everything there was to know about working for the aristocracy. This match-made-in-Copenhagen was the beginning of d'Angleterre's history.

The couple settled down by the lakes of Copenhagen and opened a restaurant. Later they moved the restaurant to Kongens Nytorv (King's New Square) at the corner of Vingårdstræde in the heart of Copenhagen - and added

rooms for guests. And it is from that point we mark the official founding of the d'Angleterre - although that name wasn't added until 32 years later in 1787. The founders' and successors' talents and commitment to providing exceptional service, hospitality and comfort have been the hallmark of the d'Angleterre for more than 260 years. This tradition is the foundation of the d'Angleterre legacy.

Today, d'Angleterre's engaged owners, and every member of the staff, affectionately carry on the tradition of passion for service that has earned the hotel its 5-star Superior rating.











## ROOMS AND SUITES

In 2011, d'Angleterre closed for 23 months for a head-to-toe renovation that infused the hotel with 21st-century strength and technology – yet retaining every aspect of the building's classic grace and elegance.

Each of the spacious and stylishly decorated rooms and suites have modern touches that complement the traditional design to exquisite effect. And each is ideal for any visit – be it for business, pleasure or entertainment.

Each guest room features grand bathrooms and individual state-of-the-art in-room climate control, entertainment and

technology. Many of the suites have balconies with epic views of the Danish capital.

The Royal Suite - providing living space of up to 400 square meters (4,305 square feet) - offers lavish fabrics and furnishings in a sophisticated, classical style with contemporary touches. Overlooking one of the city's most classic squares: Kongens Nytorv, the Royal Suite offers a breathtaking view of the Royal Danish Theatre and Nyhavn.

The d'Angleterre suites offer individual interior inspired by local notabilities and former guests like Hans Christian Andersen.









## RESTAURANT MARCHAL

Our Marchal restaurant reflects the culinary love that has quite literally been at the heart and soul of the d'Angleterre since 1755. The tradition of fusing passion and culinary art continues at Marchal.

Copenhagen is the world-leader in creative cuisine, and Marchal together with the Executive chef Jakob de Neergaard strives to make the d'Angleterre dining experience

appealing to all the senses. Fusing a modern urban touch with culinary passion Marchal's Michelinawarded cuisine brings a classic French twist to revolutionary Nordic cuisine.

In the spring, summer, fall and Christmas, Marchal spreads out onto the terrace and sidewalk of Kongens Nytorv.









## BALTHAZAR

Balthazar Champagne Bar is first and foremost about Champagne – about celebrating life in an ambiance of urbaneness – alone, as a couple, or with friends. With its separate entrance, chic Copenhageners come to revel in the voguish décor and hot tunes courtesy of our DJs. Enjoy an extensive selection of Champagnes from more than 42 different makers or a signature cocktail. You can feed your appetite for sophisticated snacks all complemented by the beautiful décor and international ambience.

Welcome to Balthazar – Copenhagen's tribute to joie de vivre.







## KRUG AFTERNOON TEA

Take one of the finest British traditions, combine it with Champagne and give it a Scandinavian touch – and you have d'Angleterre's lavish Sunday Afternoon Tea.

In cooperation with KRUG Champagne, d'Angleterre has reinterpreted the classic English Afternoon Tea and it is served in the beautiful Gallery Hall with high ceilings and imposing chandeliers.

Untraditional and eclectic specialties are featured – like lobster and truffles.

Using the finest china 'Emperor's Garden' from Fürstenberg, our team of attentive staff is on hand to make sure your Afternoon Tea at d'Angleterre will be unforgettable.

Afternoon Tea is served every Sunday from 3pm to 5pm.





## CREATIONS STUDIO

d'Angleterre has always been known for its elegant design, flowers, décor and discreet sense of style.

Now, the hotel has opened the doors to a world that had previously been reserved only for d'Angleterre's guests.

The d'Angleterre CREATIONS affords guests, admirers and design aficionados the luxury of taking the best of d'Angleterre home with

them – beautiful floral creations, signature flowerboxes, exclusive blankets, exclusive scented candles, grand coffee table books, selected pieces of furniture and much more.

Each season we carefully select the most alluring products in keeping with the d'Angleterre's unique sense of taste and style.

Our creative team will be pleased to inspire you.





## MAISON D'ANGLETERRE

MAISON d'Angleterre is a culinary destination for discerning connoisseurs. Here you will find the finest delicacies from the Michelin-starred kitchens of Marchal, along with many other wonderful products from the region to indulge both the palate and the soul.

In the morning, MAISON d'Angleterre smells of freshly brewed coffee and warm house made croissants. And in the afternoon, our skilled confectioner serves a little piece of heaven - a beautifully designed cake to be enjoyed either in-house at MAISON or for

takeaway in one of our cute MAISON cake boxes. The MAISON d'Angleterre concept has been created of the desire to bring the gastronomic cuisine and rarefied taste experiences of Marchal beyond the walls of d'Angleterre, to the streets of Copenhagen and its passersby.

The shop is stocked daily with freshly baked cakes, pastries and other refined delicacies. And as the seasons change, the selection changes as well, but there are certain products that you will always be able to find on the shelves.





## WEDDINGS

As the most luxurious and historic hotel in Scandinavia, d'Angleterre is the perfect setting for one of the most special days of your life.

Suitable for every kind of wedding and wedding reception, d'Angleterre ensures nothing but the perfect memory for every couple.

With the timeless elegance of our venues, we offer you ultimate opulence whether your dream is a gala fairytale wedding or an intimate and romantic reception.

Our dedicated and specialized events team will assist you in the planning and execution of your wedding - ensuring a seamless experience, creating perfect and lasting memories.







## EVENTS

Over the years, the d'Angleterre has hosted countless historic events including formal galas, weddings, diplomatic assemblies and royal occasions.

The historic Palm Court and the majestic Louis XVI Ballroom continue to be the most desired venues in Copenhagen.

Our beautiful Champagne bar Balthazar and the stunning CREATIONS Studio are also available as event spaces for elegant receptions for up to 100 guests.





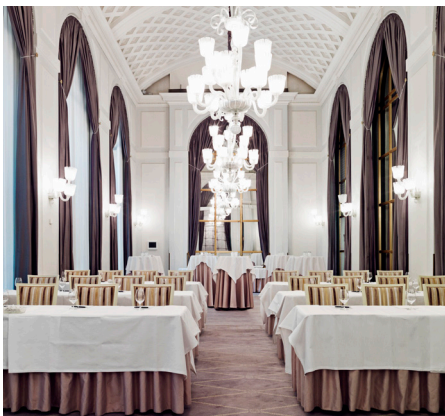

## MEETINGS

The hotel's refurbished private function rooms offer the ultimate setting for tailor-made meetings, product launches, events and larger conventions.

All meeting spaces are equipped with state-of-the-art audiovisual equipment, as well as wireless and wired high-speed internet connectivity.

A dedicated and specialized events team will assist in the planning and execution of each event to ensure a seamless experience, creating perfect and lasting memories.

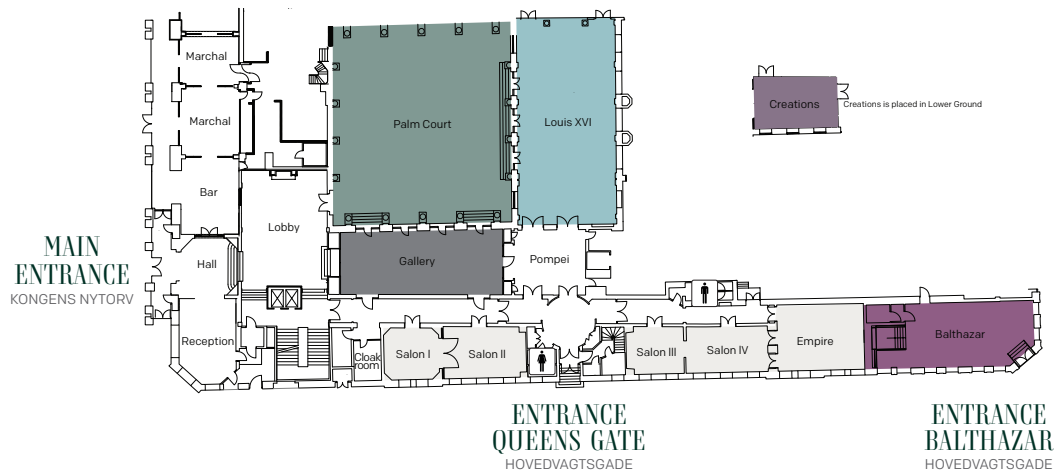

	Cabaret	Classroom	U-shaped	Theatre	Cocktails	Round Dining Tables	Boardroom	Dimensions Meter	Dimensions m <sup>2</sup>	Floor-to-ceiling height * Meter	Door width Meter	Door height Meter
Salon I	-	-	-	-	15	10	10	5,5 x 5,2	29	3,7	1,45	2,26
II	-	-	-	-	25	20	20	8,3 x 5,1	42	3,7	1,45	2,70
III	-	-	-	-	15	10	10	5,7 x 4,6	26	3,6	1,45	2,37
IV	-	-	-	-	25	20	20	8,3 x 4,5	37	3,5	1,42	2,81
Empire	25	25	25	25	50	50	25	8,8 x 6,5	57	3,6	1,40	2,80
Gallery	35	50	40	100	100	60	30	15,6 x 6,0	94	7,2 *	2,50	2,50
Louis XVI	70	90	50	200	250	130	50	18,7 x 9,8	183	7,2 *	1,80	2,50
Palm Court	120	196	60	300	400	300	-	18,0 x 16,1	290	9,1	1,80	2,40
Balthazar	-	-	-	-	100	-	-	16,0 x 6,0	96	4,1	2,10	3,50
CREATIONS	-	-	-	-	40	-	-	10,5 x 5,2	54,6	2,4	0,85	2,00/2,05

\*Chandeliers might lower ceiling height  
All mentioned numbers are excluding stage and AV equipment





## AMAZING SPACE SPA AND POOL

The spa at d'Angleterre was unveiled in 2013, designed to ensure a tranquil environment for the mind, body and soul. This urban spa driven by Amazing Space offers an expansive menu of signature treatments, a lounge for relaxation and revitalization and a fully equipped fitness studio.

A visit to Amazing Space d'Angleterre is augmented by healthy drinks, aromatherapy scents, relaxing music and exotic flowers. The specially selected and trained spa therapists provide nourishing and healing treatments ranging from facials based on the

latest technology to Nordic spa treatments, sports massages, reflexology, acupuncture, nutritional and dietary advice. Amazing Space also offers a wide variety of deluxe manicures and pedicures as well as hair styling and makeup sessions.

Our magnificent marble swimming pool is the only pool in central Copenhagen. Our fitness area is equipped with professional TechnoGym equipment. Access to the fitness studio, swimming pool and the relaxation lounge is complimentary for guests in residence.









THE LEADING HOTELS  
OF THE WORLD®