

THE PRINCIPLE BEHIND THE TRANSFORMATION

The Waterfront development is based on a precise analysis of the site and the historical character of Stavanger.

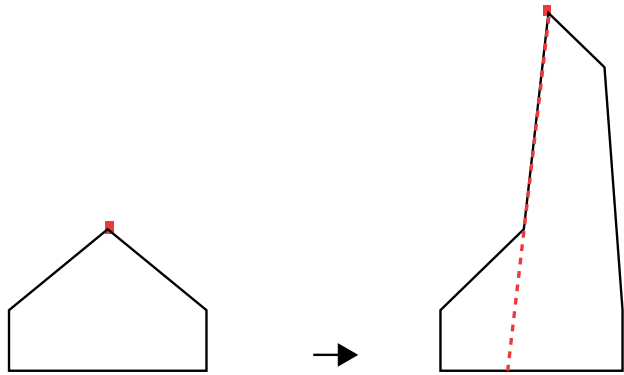

**STARTING POINT**  
The form of the historical wooden houses at the core of Stavanger.

**TRANSFORMATION**  
Inspired by the Norwegian steep mountains, one part of the building structure is stretched vertically, by which a new form appears.

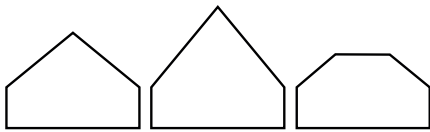
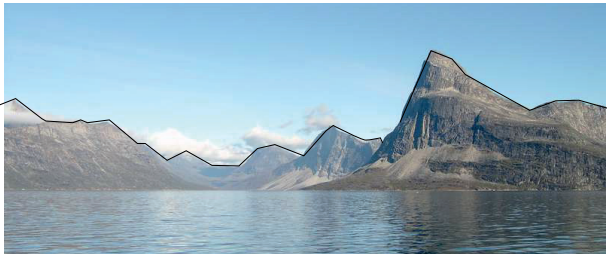

The compactness of the historical wooden houses at the core of Stavanger.

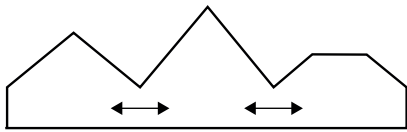

The Waterfront development is compacted into a cohesive urban structure.

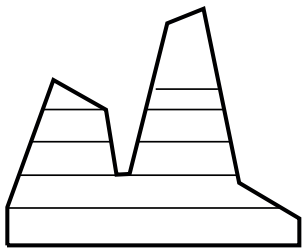

The scale of the urban structure is increased, but the human scale remains intact as the lower roof margin preserves its height.

THE PRINCIPLE BEHIND THE BUILDING STRUCTURE

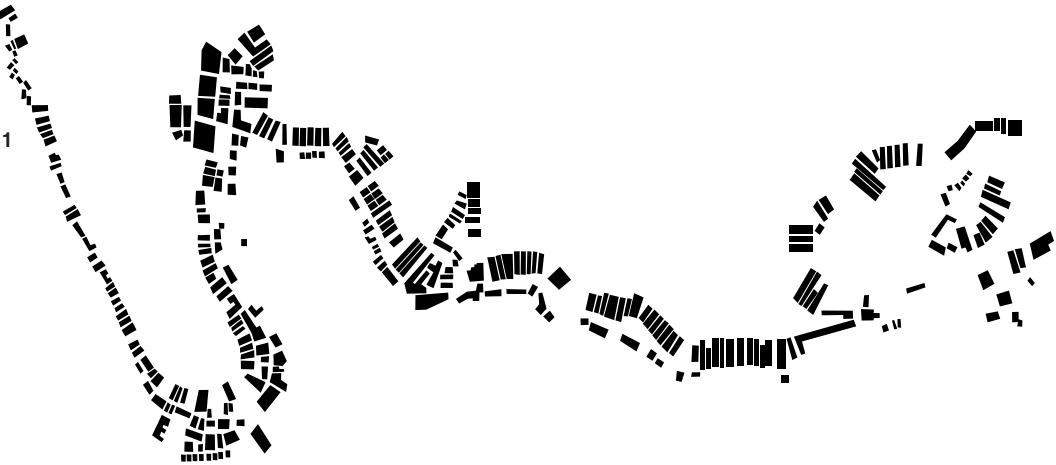

**1. THE OLD WOODEN BUILDINGS WIND ALONG THE BAY**

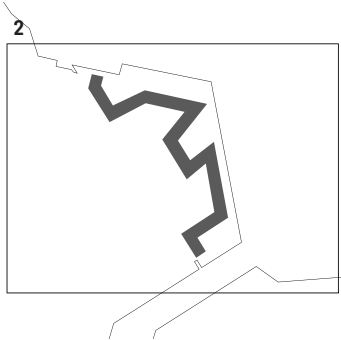

**2. THE WATERFRONT WINDS ALONG THE HARBOUR FRONT**

Inspired by Stavanger's row of old buildings along the bay, the Waterfront winds along the harbour front and creates a dynamic and cohesive building structure.

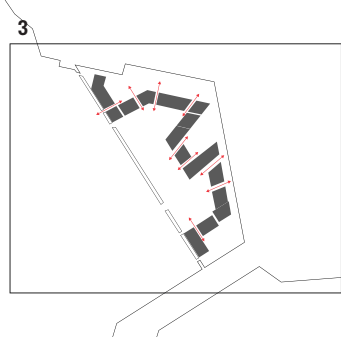

**3. THE WATERFRONT CREATES DIFFERENT BUILDING TYPOLOGIES**

The building structure is divided into different sizes and shapes in order to create connecting links and utilise the local climate conditions and the magnificent view of the sea.

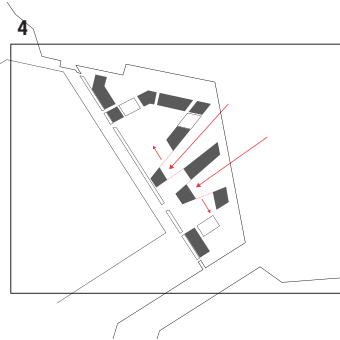

**4. & 5. THE WATERFRONT DISPLACES ITS BUILDING VOLUMES**

The separate building volumes cut themselves off from the basic building structure in order to refine the view of the sea and create varying outdoor areas and connecting links.



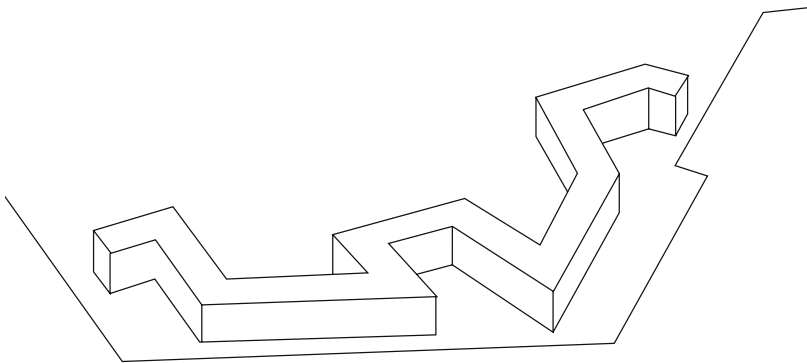

**1. BUILDING STRUCTURE**  
The coherent building structure connects the different locations on the site.

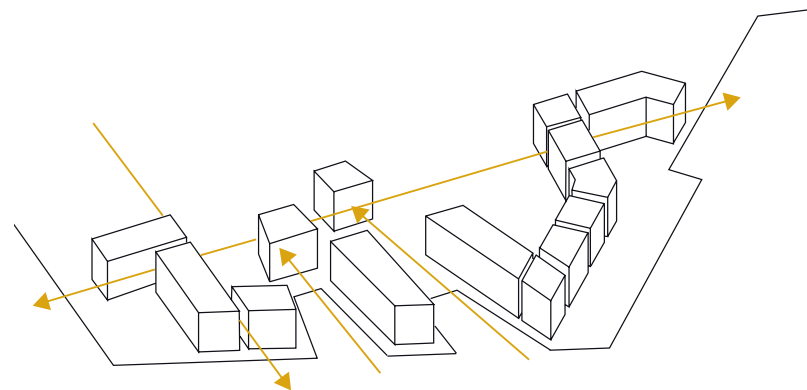

**2. DIVIDING THE BUILDING STRUCTURE**  
By dividing the building structure into separate units the project creates varying spaces and routes.

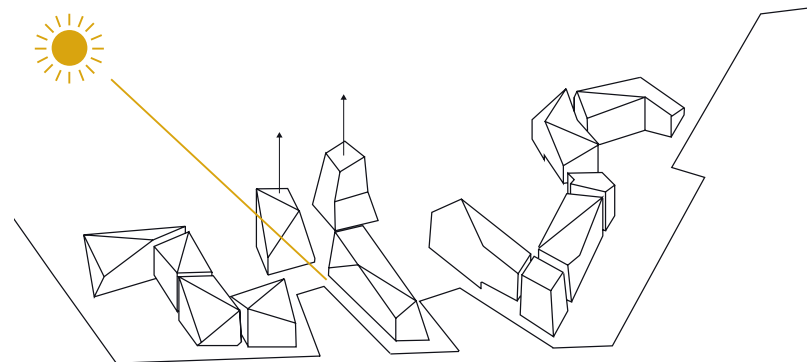

**3. OPTIMISING THE LIGHTING CONDITIONS**  
By designing the building structure in proportion to the movement of the sun and creating irregular carvings the project optimises the lighting conditions and tones down the scale of the building structure.

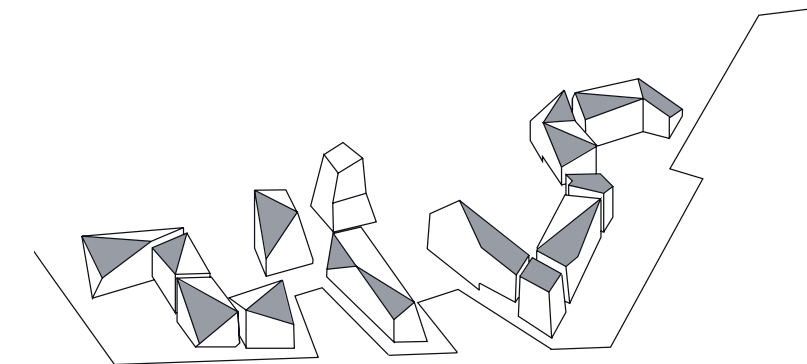

**4. COHERENT EXPRESSION**  
The carvings create a coherent expression that unites the building structure.



PHOTO FROM THE CONSTRUCTION PERIOD / APRIL 2014